

**Valves / Safety Vents / Membrane Type Safty Valves With Fixed Pressure**

**CONSTRUCTIVE PROPERTIES**

	STANDARD	OPTIONAL
Meterial of Membrane	NBR	-
Adjusting Bolt	Steel Plated	-
Discharge Connection	G 1/2'' B	-
Tension Spring	Spring Steel Plated	-
Installation Connection	R 1/2"	-

**USAGE PROPERTIES**

Storage Temperature	-20 ... +60 °C	-
Conformity	CE 0036	-
Max.Water Temp.	110 °C	-
Max.Pressure	16 bar	-

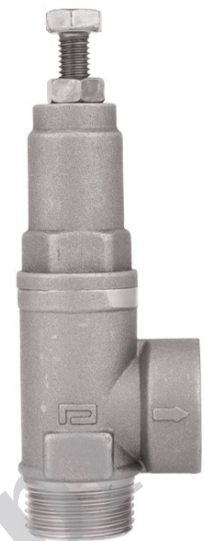

**0979**

Membrane Type Safty Valves With Fixed Pressure

www.Laheghi.com

Valves / Safety Vents / Membrane Type Safty Valves With Fixed Pressure

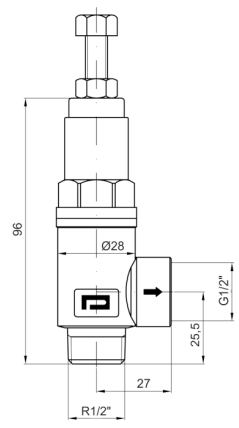

Model No: 0979

www.Laheghi.com

**PAKKENS® VALF**

**Security Valves**

▶ Adjustable Security Valve

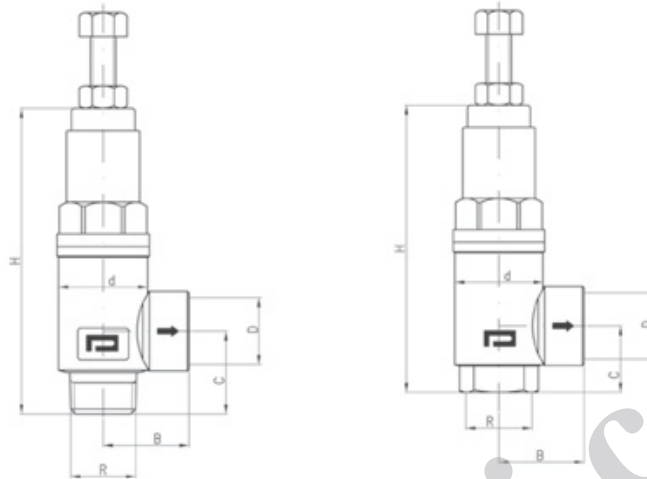

Connection Sizes								
	Code #	R	D	H	B	C	d	Kg
Male	0979000000	R 1/2"	G 1/2"	96	27	25.5	ø 28	0,96
	0978000000	R 3/4"	G 3/4"	102	29	30	ø 28	0,102
	0977000000	R 1"	G 1"	113,5	35	35	ø 40.5	0,113
Female	0979100000	G 1/2"	G 1/2"	91.5	27	21	ø 28	0,92
	0978100000	G 3/4"	G 3/4"	97.5	29	25	ø 28	0,98
	0977100000	G 1"	G 1"	108.5	35	30	ø 40.5	0,109

▶ Security Valve for Steam

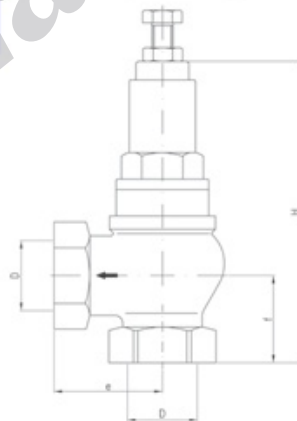

Connection Sizes					
Code #	D.	H	e	f	Kg
0974010000	G 1/2"	100	35	30	0,420
0975010000	G 3/4"	112	40	32	0,650
0976010000	G 1"	131	47	40	0,878
0974910000	G 1 1/4"	154	56	44	1,385
0975910000	G 1 1/2"	177	62	47	1,825
0976910000	G 2"	200	75	59	2,865

Security Valves